

## BALL CHECK VALVES

Check Valves are widely used for both sanitary and industrial applications to prevent backflow of product.

Ball Check Valves are designed to allow full product flow during processing. Once the product flow stops the ball rolls back to the seat at inlet preventing back flow. Ball Check Valves are commonly used with liquid products and installed horizontally. Sizes range 1 1/2" - 3".



### BALL CHECK VALVE SPECIFICATIONS....

<b>Size:</b>	1 1/2" through 3" sizes available
<b>Materials:</b>	T316L
<b>Finish:</b>	32 Ra $\mu$ -in. ID/OD
<b>Connections:</b>	Clamp, Buttweld, other connections available upon request
<b>Seats / Seals:</b>	Buna ball and seats are standard - other seats available are Viton®. Metal detectable and EPDM are available as a special option

### ORDERING SPECIFICATIONS....

#### Specify:

- Quantity
- Product Description or Part number
- Size

#### Important Features:

- Precision machined seat to ensure positive shut off
- Two-piece design construction for easier alignment during installation
- Conform to 3A Sanitary Standards for vacuum breakers and check valves. Standard number 58-02. Certificate authorization number 3573. Seats and seals are FDA approved.
- Valves marked with heat numbers for full identification and traceability. MTR'S are available upon request

## Ball Check Valve

### PARTS BREAKDOWN

- 1. Seat body - (Clamp)
- 1W. Seat body - (Weld)
- 2. Cap
- 3B. Ball-(Buna-N)
- 3V. Ball-(Viton®)
- 4. Angle body
- 4W. Angle body-(Weld)
- 5. Body clamp
- 6B. Body gasket-(Buna-N)
- 6V. Body gasket-(Viton®)
- 7. Cap clamp
- 8B. Cap gasket-(Buna-N)
- 8V. Cap gasket-(Viton®)

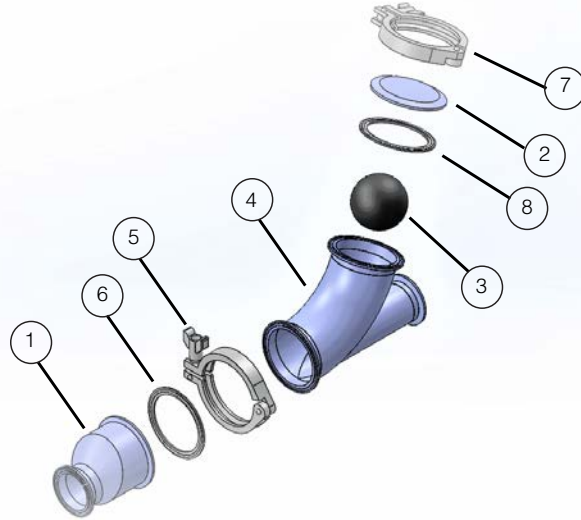

### PART NUMBER SEQUENCE WHEN ORDERING COMPLETE VALVE:

Clamp connections      EG45BY-6 (valve size)  
 Weld ends              E45BYWW-6 (valve size)  
 Note: If Viton® elastomers are required, add "V" after size  
 Metal detectable elastomer options are available. Please contact VNE for details.

### PART NUMBER SEQUENCE WHEN ORDERING REPLACEMENT PARTS:

BCV (item number) - (valve size)  
 Example: BCV3B-1.5 = Buna-N ball for 1.5 valve

Valve Size	Actual Size	Overall Length		Approx. Wt. Lbs.
	Ball	EG Clamp	E Weld	
1 1/2	2.125	10.000	9.000	4.80
2	2.625	11.000	10.000	6.30
2 1/2	3.312	14.125	13.125	10.20
3	3.312	13.625	12.625	11.50

