



# VNE

Neumo Ehrenberg Group

## Product Announcement EG14AM7 Length Update

We are pleased to announce that we are manufacturing and have inventory on .5" and .75" OD size B length ferrules in the 1.125" lengths. Previously we have manufactured these with a 2" length. You may be aware the industry standard for the 1.5" through 4" od size B length ferrules are 1.125". This new change in length on the .5" and .75" ferrules will allow harmony between the product range and better match the industry standard.

As of April 1st, 2019 any new orders being placed for EG14AM7-6L.5, EG14AM7-6L.75, LA-EG14AM7-6L.5 and LA-EG14AM7-6L.75 will be processed and shipped as the new 1.125" length. If you require the 2" length ferrules please update your part number/item number references as shown in the updated VNE literature.

As customer's transition to the new 1.125" lengths we do anticipate the 2" length ferrules will be discontinued at some point in the future. If you have any questions or concerns in regards to this transition please contact your regional sales manager (608.756.4930 or 800.356.1111)



# Clamp Fittings

## EG9 - CROSS

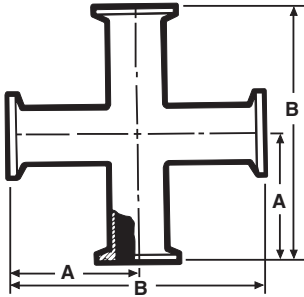

Size Tube OD	A	B
1	2.375	4.750
1 1/2	2.750	5.500
2	3.500	7.000
2 1/2	3.500	7.000
3	3.750	7.500
4	4.500	9.000
6	8.875	17.340

## EG14AM7 - WELDING FERRULE

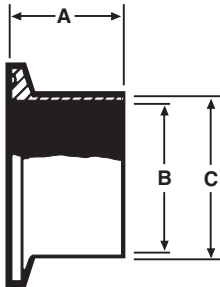

Size Tube OD	A	B	C
1/2*	1.125	0.370	0.500
3/4*	1.125	0.620	0.750
1	1.125	0.870	1.000
1 1/2	1.125	1.370	1.500
1 1/4	1.125	1.120	1.250
2	1.125	1.870	2.000
2 1/2	1.125	2.370	2.500
3	1.125	2.870	3.000
4	1.125	3.834	4.000
5	1.500	4.782	5.000
6	1.500	5.780	6.000
8	1.500	7.782	8.000
10	1.500	9.732	10.000
12	1.500	11.732	12.000

\*Length changed from 2.000 to 1.125 on January 1st, 2019

## EG14AM7 - L - LONG WELDING FERRULE

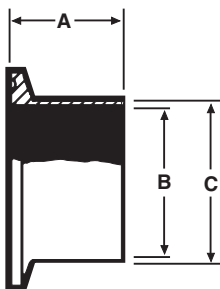

Size Tube OD	A	B	C
1/2	2.000	0.370	0.500
3/4	2.000	0.620	0.750

\*Order as EG14AM7-6L .5L / EG14AM7-6L.75L

## LA-EG14AM7 - WELDING FERRULE

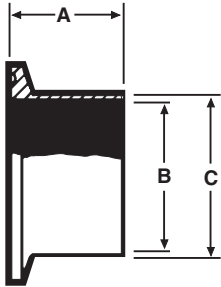

Size Tube OD	A	B	C
1/2*	1.125	0.370	0.500
3/4*	1.125	0.620	0.750
1	1.125	0.870	1.000
1 1/2	1.125	1.370	1.500
1 1/4	1.125	1.120	1.250
2	1.125	1.870	2.000
2 1/2	1.125	2.370	2.500
3	1.125	2.870	3.000
4	1.125	3.834	4.000
6	1.500	5.780	6.000
8	1.500	7.782	8.000
10	1.500	9.732	10.000
12	1.500	11.732	12.000

\*Length changed from 2.000 to 1.125 on January 1st, 2019

## LA-EG14AM7- L - LONG WELDING FERRULE

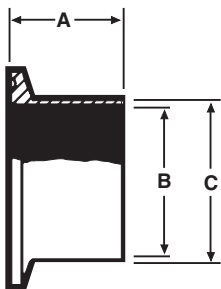

Size Tube OD	A	B	C
1/2*	2.000	0.370	0.500
3/4*	2.000	0.620	0.750

\*Order as LA-EG14AM7-6L .5L / LA-EG14AM7-6L.75L